



# AWES

Advanced Well Equipments  
Standardization Group

## An introduction to AWES

October 2015

© OTM Consulting Ltd, 2015. The information contained in this document is believed to be accurate, but no representation or warranty, express or implied, is made by OTM Consulting Limited as to the completeness, accuracy or fairness of any information contained in this document, and we do not accept any responsibility in relation to such information whether fact, opinion or conclusion that the addressee may draw.

A JIP managed by OTM Consulting Ltd



# AWES promotes reliable advanced well equipments across the industry

AWES

Advanced Well Equipments  
Standardization Group

## Our AWES group objective is:

“To improve the **reliability of advanced well equipment** through the development of **published industry standards and recommended practices** for the qualification of the relevant completions equipment”

We achieve this through collaborative discussion and information sharing during regular teleconferences and 3 meetings per year

Group activities include:

- Development of test qualification procedures and standards
- Definition of how to measure sensor system performance
- Sharing of results from prior testing work & lessons learnt
- Setting a standard for vendors in terms of qualifying their technology for an advanced well application to raise the level of requirements
- Gaining confidence in lifetime expectancy of downhole sensors by standard testing
- Reducing the need for oil companies to run their own independent qualification testing
- Assisting vendors to understand oil company requirements
- Providing QA/QC

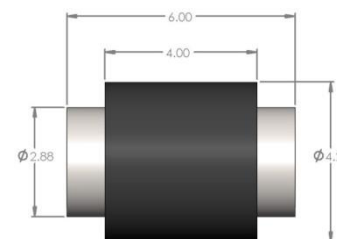

## The first AWES Recommended Practice is complete and available to members and non-members via the AWES website

- AWES Recommended Practice For the Selection, Manufacture, Testing and Use of Open Hole Zonal Isolation Devices
  - Published September 2014 on AWES website
  - Licensed to API for publication as an API industry standard
- Plan to have a further 3 Recommended Practices published by the end of 2015:
  - AWES Recommended Practice for the Qualification of Tubing Encased Conductor (TEC)
  - AWES Recommended Practice for the Selection, Manufacture, Testing and Use of Downhole Sensors
  - AWES Recommended Practice for the Performance Modelling and Testing of ICD Devices

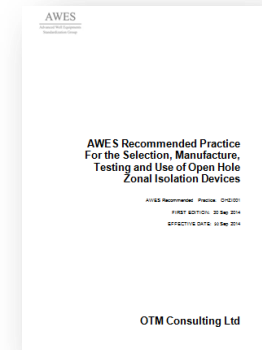

## We maintain three workstreams to address priority topics

- As one group completes its RP and publishes/licenses to another body, the next group stands up
- Membership adjusts to reflect current focus
- Proposed group changes based on feedback from past meetings

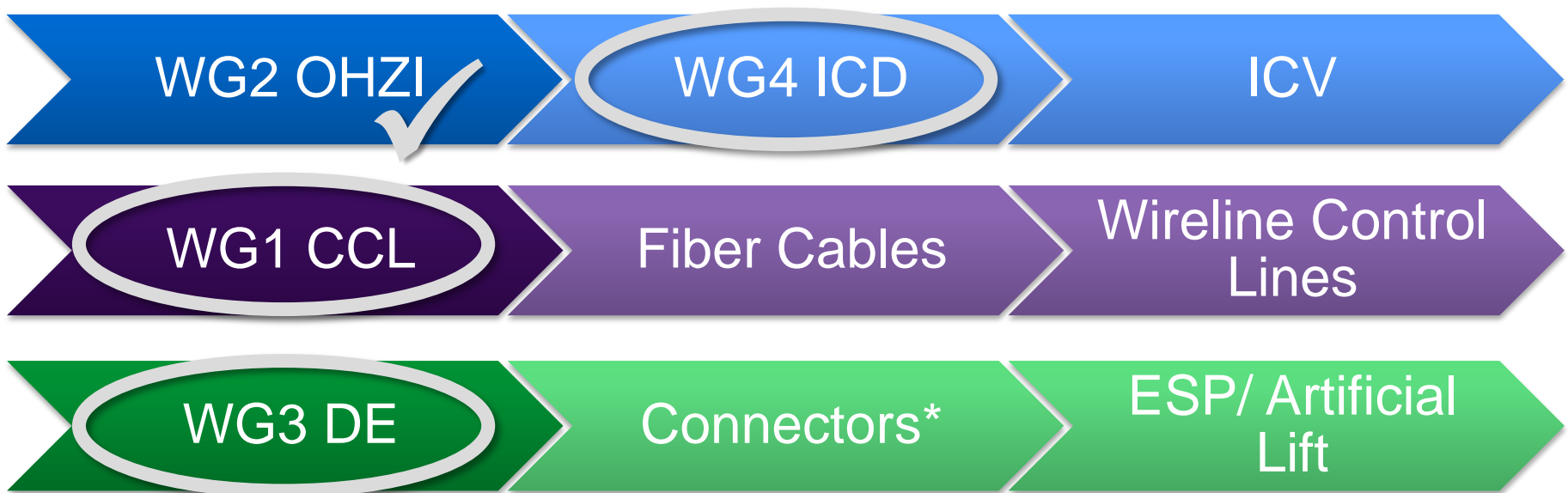

\*Clamps, connectors and splicing, both dry-mate and wet-mate

## OTM Consulting Ltd

[www.otmconsulting.com](http://www.otmconsulting.com)

Boston    Cambridge    London    Houston    Dubai

### Sagentia Group

Harston Mill  
Harston  
Cambridge  
CB22 7GG  
UK

Tel: +44 1223 875200  
[www.sagentia.com](http://www.sagentia.com)

### OTM Consulting Ltd

Friary Court  
13-21 High Street  
Guildford, Surrey  
GU1 3DG  
UK

Tel: +44 1483 598000

### OTM Consulting Inc

3040 Post Oak Blvd  
Suite 1212  
Houston  
TX 77056  
USA

Tel: +1 832 581 2438

### OTM Consulting Ltd

Reef Tower  
Sheikh Zyed Road  
PO Box 115738  
Dubai  
UAE

Tel: +971 4448 7595

A JIP managed by OTM Consulting Ltd

